

Able Hands Together Being a Co-Farmer



WELCOME TO ABLE HANDS TOGETHER

Able Hands Together, Little Wishford Farm, Warminster Rd, Stoford SP2 0PS.

If you have any problems finding the farm call 07725 734 662.



What to bring with you to the Farm

FOOTWEAR - Don't forget to bring sensible footwear

- The farm can get muddy so when wet bring wellies
- You CANNOT wear bare feet, flip flops, or open toed shoes.
- You can wear crocs, trainers, leather shoes. If you're worried you give us a call and ask.

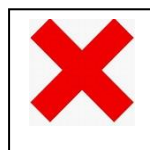

FOOD AND DRINK

- Bring your own hot or cold drinks
- Bring your own snacks, hot or cold food

Able Hands Together Being a Co-Farmer



Arriving at Able Hands Together?

There is an electronic gate with a sign saying “Little Wishford Farm,” when you arrive at the farm.

Drive really CLOSE to the gate and it will open automatically.



Drive down the drive through the stone arch directly ahead of you and park in the yard.



We are very happy to welcome you to the farm at Able Hands Together and we really hope you will enjoy being a Co-Farmer.

Able Hands Together Being a Co-Farmer



What does a Co-Farmer do?

We want you to have fun. As a Co-Farmer you help run the farm.

Paula, Nic, Tash, Chris and Gareth are in charge of running the farm and they will work with you.

This is Paula.



This is Nic.



This is Tasha



Able Hands Together Being a Co-Farmer



This is Gareth



This is Chris



This is Katherine



This is Gemma



Able Hands Together Being a Co-Farmer



Looking after the animals

Come and meet the goats, sheep and alpacas and help to feed them.



Able Hands Together Being a Co-Farmer



You can meet the rabbits and Guinea pigs. They need food and water and they like to have their cages cleaned out.



The chickens and the ducks like to be fed and have their water changed so that they have clean water to drink and swim in!



Able Hands Together Being a Co-Farmer



And this is Rosie the tortoise.



You can help look after the plants, they might need watering, pruning or weeding.



Able Hands Together Being a Co-Farmer



Opening times, Monday to Friday

Monday to Friday



We are **open** at 9.30am



We **finish** at 3pm

When you arrive a **member of staff** will be there to greet you.

We are closed on Bank Holidays

What to do with your shoes

When you arrive you will take off your outside shoes or wellies and leave them on the shoe shelf before you put your inside shoes on and go into the pods.

When you go out into the farm, you will put your outside shoes or wellies back on.

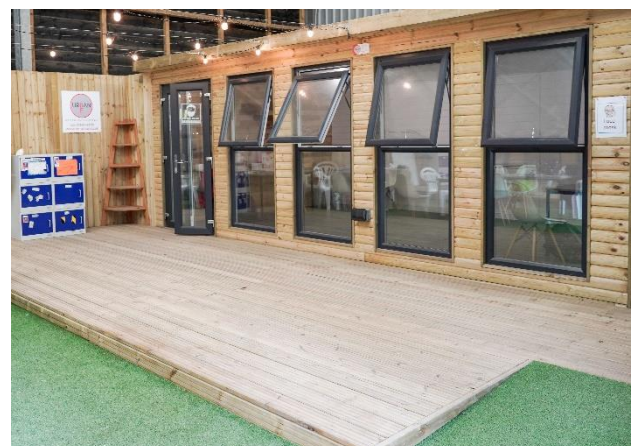

Able Hands Together Being a Co-Farmer



Tea and Coffee Break

Break times vary, but we aim to have a tea break at 10.30.

Do bring your own flask or drink.

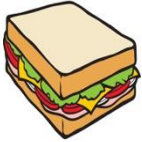

Lunch

Please bring your own lunch.



We will eat at **12.00**

If the weather is nice, we can eat outside on the tables outside.



If it is cold, we can eat in the pods.



Able Hands Together Being a Co-Farmer



Toilets

The toilets are very close by in cabins outside. There is a women's and a men's toilet.



Enjoy your day!

Able Hands really want you to enjoy being at the farm and working with the animals and your fellow Co-Farmers. There is no right or wrong in what you do. If there is something you are not happy doing then chat with Paula, Nic, Tasha, Chris or Gareth.

At the end of the day

Please can you or a one-to-one fill in the Daily Summary Sheet. This is really helpful for us to find out how you have enjoyed your time during the day, and how we can make your day a happy one.

Able Hands Together Being a Co-Farmer



Boundaries

We are not allowed to go into some parts of the farm, it is a working farm and there are some parts we forbidden to go into. There are stables with horses on the farm. We are not allowed to go into the stables. A member of staff will point out to you where the boundaries of the farm are.

Attendee Agreement

Here at the Able Hands Together Farm you will be working within a completely confidential and safe space. Anything you say to us or each other is said in complete confidence and cannot be repeated outside the farm boundaries, unless there is a safe guarding issue. You are expected to be respectful to others. If you have any concerns please speak to Carl.

First Aid

All staff are qualified First Aiders. The First Aid Kit is located at the entrance to the pods.

Personal Details

Information will be stored in line with General Data Protection Regulation.

Able Hands Together Being a Co-Farmer



The Fire Assembly Point

The fire warden is Paula, who will point out the two assembly points. If there is a fire, leave all your belongings behind, and walk calmly to the Fire Assembly points. Do not return to the building or the area that is on fire. Wait at the assembly point until the Fire Warden gives you permission to move.



COVID Instructions

The farm is Covid safe. We ask all Co-Farmers to take a quick Lateral Flow Covid test in the morning before they come to the farm for the day, but only if you are able to. We will give you some tests if you need them. If you are not able to take a test, a member of staff will take your temperature before you arrive.

As well as taking the test or your temperature:

- Please be mindful of social distancing.
- Remember to wash hands regularly.
- There are disinfectant stations around the farm for you to sanitise your hands.
- You can eat in the pods if it is cold.
- Masks will have to be worn when inside unless you are eating.
- Coffee cannot be served.
- Further Covid instructions will be given on the day.

Able Hands Together Being a Co-Farmer



Other people who work at the farm

Laura and Alex work in the office, but you will often see them around the farm.

This is Laura



This is Alex



We have lots of fun on the farm. Here are some more pictures of the farm and us having fun.



Able Hands Together Being a Co-Farmer



Able Hands Together Being a Co-Farmer



Able Hands Together Being a Co-Farmer

